

A41 WARWICK ROAD ROUTE ENHANCEMENT - PHASE ONE PUBLIC CONSULTATION PLAN SHEET 4 (TYSELEY HILL ROAD TO STOCKFIELD ROAD)

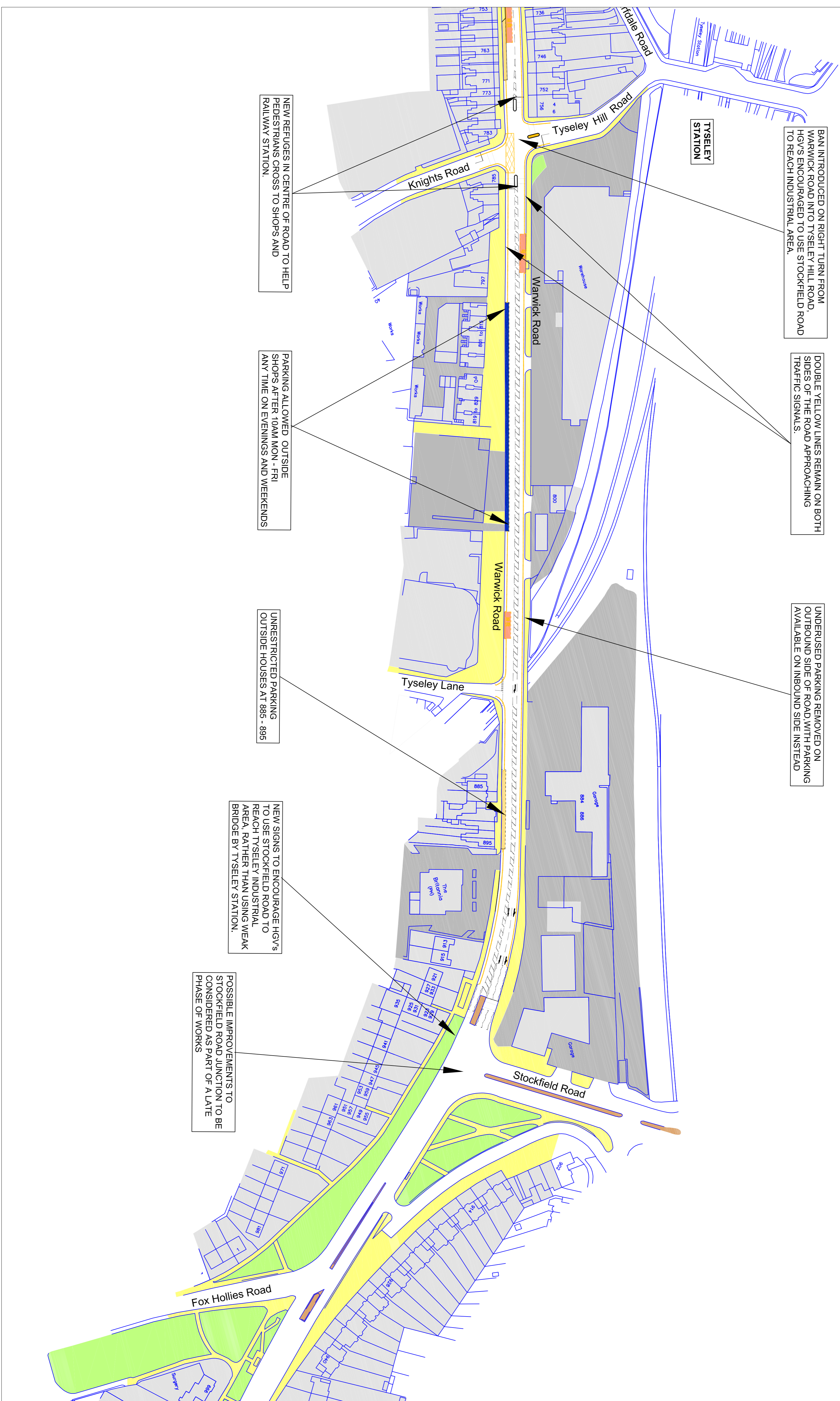

- KEY**
- Double yellow lines - no waiting at any time and no loading at peak times (7 - 10am and 4 - 7pm)
 - Parking allowed after 10am Mon - Fri and any time at evenings/weekends
 - Parking allowed at any time of day
 - Parking for 1 hour maximum Mon - Sat 8am - 6pm, unrestricted parking evenings/Sundays
 - Bus Stop (no stopping at any time for other vehicles)

DATE	REV	REVISIONS	DEN.	DES.	P.M.

Birmingham City Council
 ASSISTANT DIRECTOR DEVELOPMENT STRATEGY
 BIRMINGHAM B4 7DQ

WARWICK ROAD ROUTE ENHANCEMENTS PHASE ONE

PUBLIC CONSULTATION PLAN SHEET 4 OF 4 (TYSELEY HILL ROAD TO STOCKFIELD ROAD)

SCALE: **1:1000** STATUS: **INFORMATION**

P.M. **AJC** DESIGNER
 A.M.C. **AJC** DRAWN
 C.C.H. **CCH** REV.

DRAWING NO: **LP_GA01405_107**

DRAWING UNITS ARE METRES 1:1 SHEET

This map is based upon Ordnance Survey material with the permission of the Controller of Her Majesty's Stationery Office. Crown copyright and may be used in reproduction or adaptation in any form or by any means without the prior written permission of the Controller of Her Majesty's Stationery Office. Licence No. 100021328 Data 2010